

Berks Corporate Center 170 Corporate Drive

Reading, Pennsylvania

For Lease: $\pm 12,285$ SF Warehouse



Site Plan

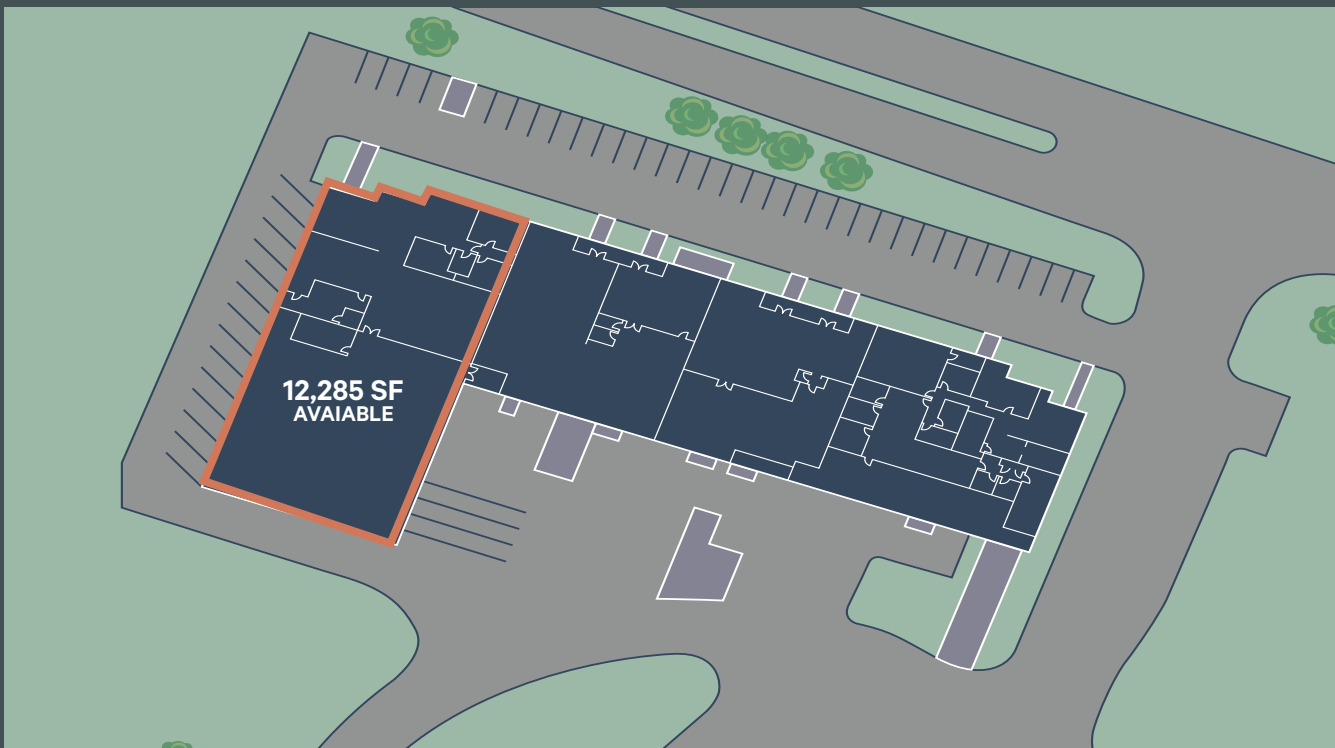

Location Map

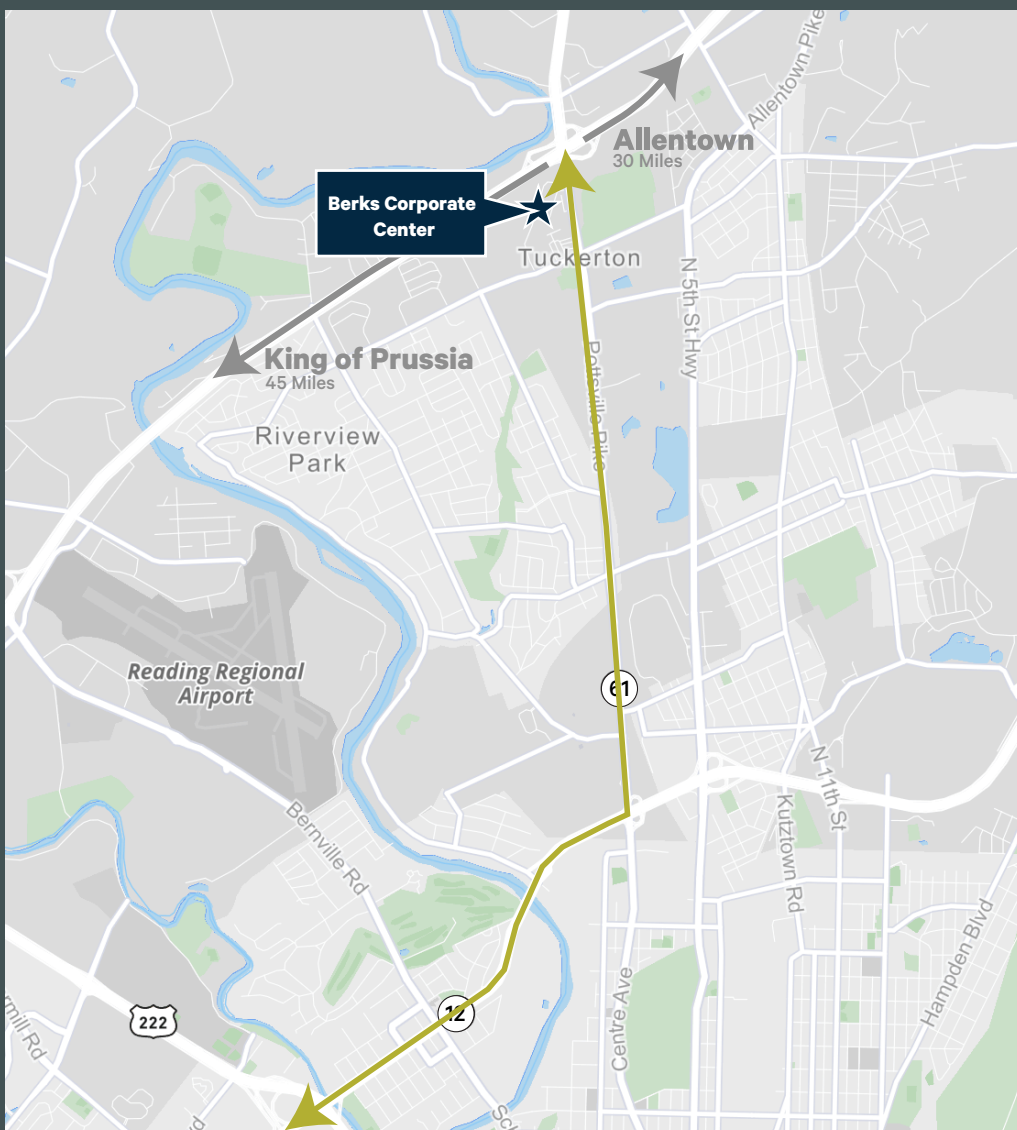

Floor Plan

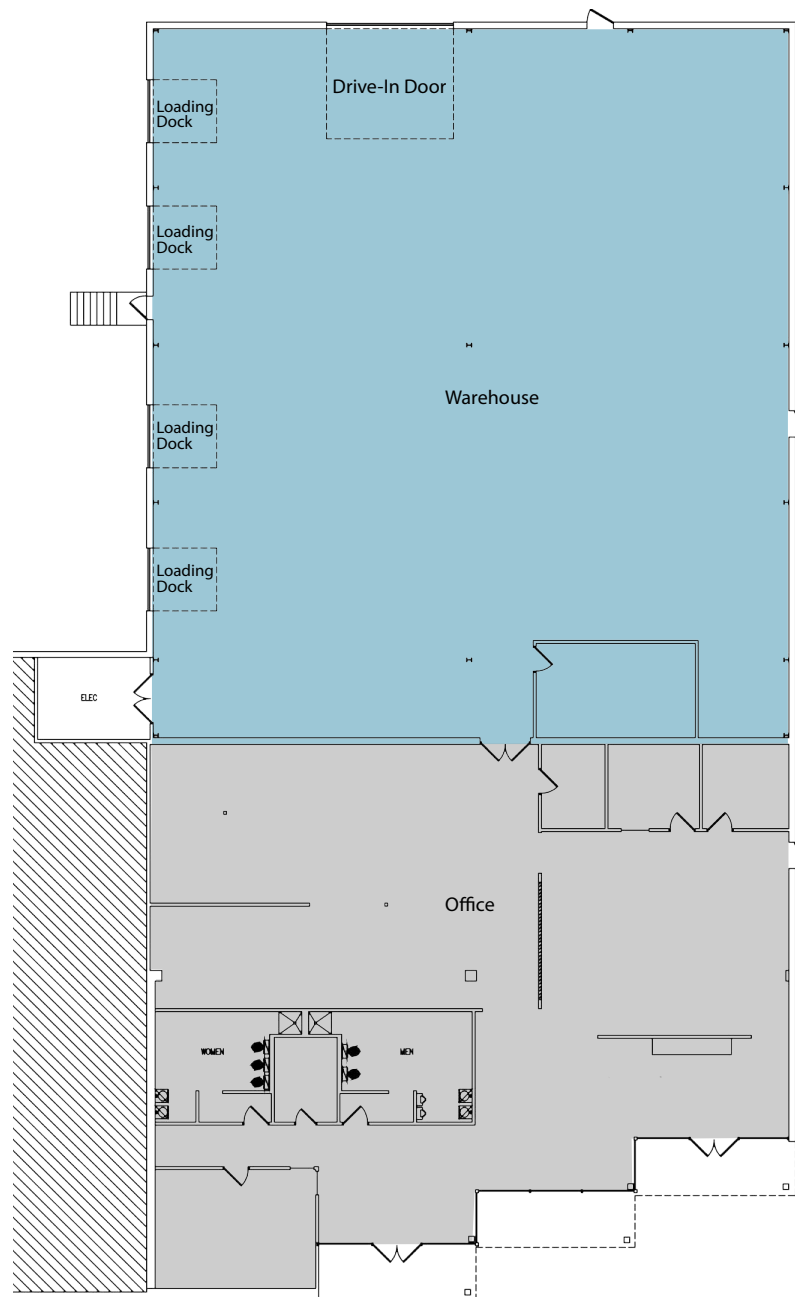

Building Highlights

Available Square Footage: ±12,285 SF

Loading: Four (4) loading docks
One (1) drive-in door (16'x14')

Warehouse Area: ±7,417 SF

Gas: UGI Utilities

Office Area: ±4,868 SF

Sewer: Muhlenberg Township Authority

Ceiling Height: 22' to Underside of Bar Joint

Water: Muhlenberg Township Authority

Column Spacing: 40' x 40'

Electric: Main Service Panel-800a 208/120v 3ph
4w Supplied by MetEd

Parking: 11.5/1,000 SF Parking Ratio

Zoning: I-1 - Limited Industrial District,
Muhlenberg Township, Berks County

Regional Map

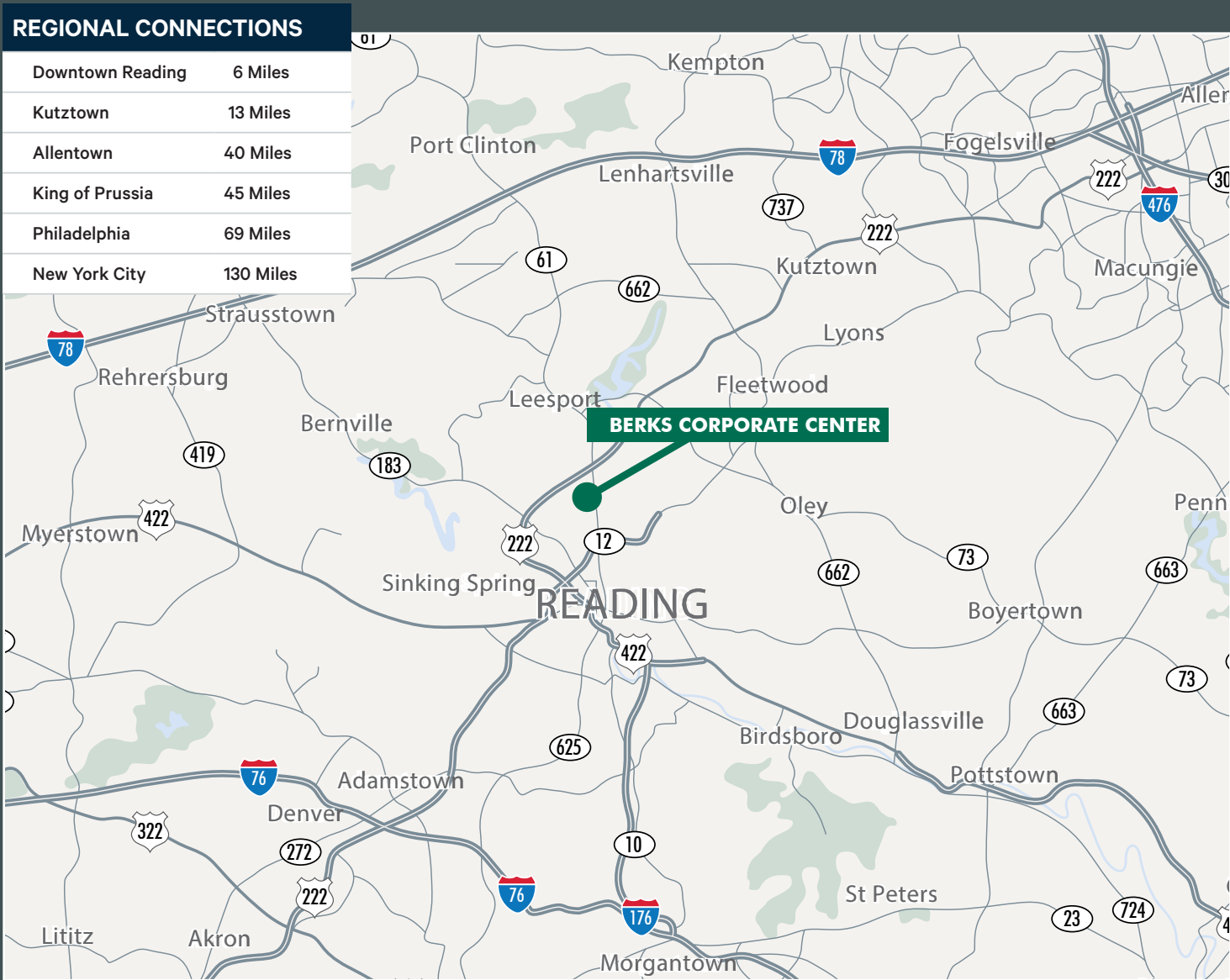

Contact Us

John LaPrise
Associate
+1 610 251 5126
john.laprise@cbre.com
Lic. PA

Paul Touhey
Executive Vice President
+1 610 251 5126
paul.touhey@cbre.com
Lic. PA, NJ, DE

CBRE, Inc.
555 E. Lancaster Avenue
Suite 120, Radnor, PA 19087
+1 610 251 0820
Licensed Real Estate Broker

© 2024 CBRE, Inc. All rights reserved. This information has been obtained from sources believed reliable, but has not been verified for accuracy or completeness. You should conduct a careful, independent investigation of the property and verify all information. Any reliance on this information is solely at your own risk. CBRE and the CBRE logo are service marks of CBRE, Inc. All other marks displayed on this document are the property of their respective owners, and the use of such logos does not imply any affiliation with or endorsement of CBRE. Photos herein are the property of their respective owners. Use of these images without the express written consent of the owner is prohibited.