

Berks Corporate Center 610 Corporate Drive

Reading, Pennsylvania

±28,057 SF Flex/Warehouse Space



Available
28,057 SF

Site Plan



Location Map



Floor Plan

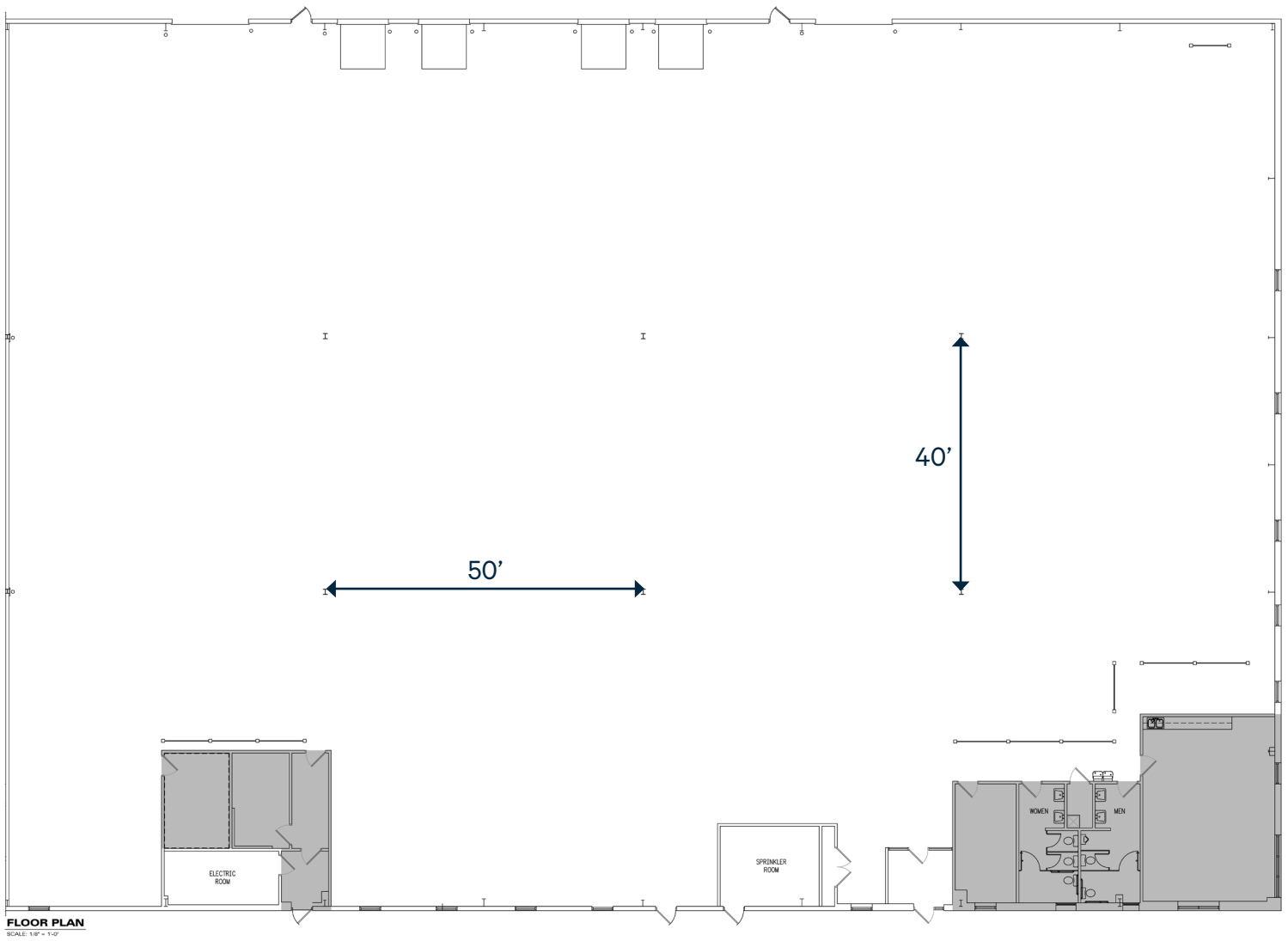

Building Highlights

Square Footage:	±28,057 SF	Loading:	Three (3) 10'x8' loading docks and One (1) drive-in doors (10'x10')
Warehouse Area:	±26,286 SF	Gas:	UGI Utilities
Office Area:	±1,771 SF	Sewer:	Muhlenberg Township Authority
Ceiling Height:	24'	Water:	Muhlenberg Township Authority
Column Spacing:	50' x 40'	Power:	Two (2) 800 amp distribution panels at 208/120 volts
Parking:	16 spaces lined in front of unit with additional parking area in the rear of unit	Zoning:	I-1 - Limited Industrial District, Muhlenberg Township, Berks County

Regional Map

REGIONAL CONNECTIONS

Downtown Reading	6 Miles
Kutztown	13 Miles
Allentown	40 Miles
King of Prussia	45 Miles
Philadelphia	69 Miles
New York City	130 Miles

Contact Us

John LaPrise
Senior Associate
+1 610 247 9323
john.laprise@cbre.com
Lic. PA

Paul Touhey
Executive Vice President
+1 610 251 5126
paul.touhey@cbre.com
Lic. PA, NJ, DE

CBRE, Inc.
555 E. Lancaster Avenue
Suite 120, Radnor, PA 19087
+1 610 251 0820
Licensed Real Estate Broker

© 2024 CBRE, Inc. All rights reserved. This information has been obtained from sources believed reliable, but has not been verified for accuracy or completeness. You should conduct a careful, independent investigation of the property and verify all information. Any reliance on this information is solely at your own risk. CBRE and the CBRE logo are service marks of CBRE, Inc. All other marks displayed on this document are the property of their respective owners, and the use of such logos does not imply any affiliation with or endorsement of CBRE. Photos herein are the property of their respective owners. Use of these images without the express written consent of the owner is prohibited.