

Industrial & Logistics | For Lease

CBRE

# Berks Corporate Center 170 Corporate Drive

Reading, Pennsylvania

For Lease: ±24,000 SF Flex/Warehouse Space



# Site Plan

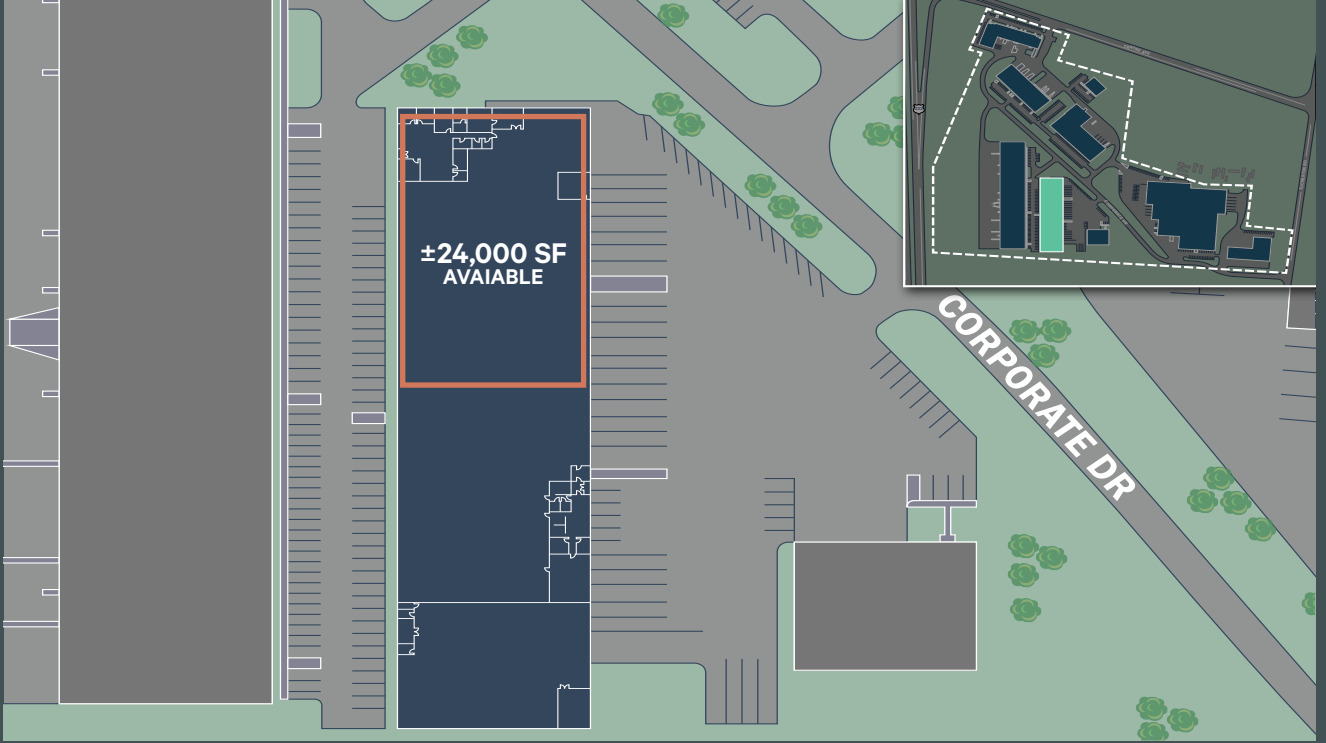

# Location Map

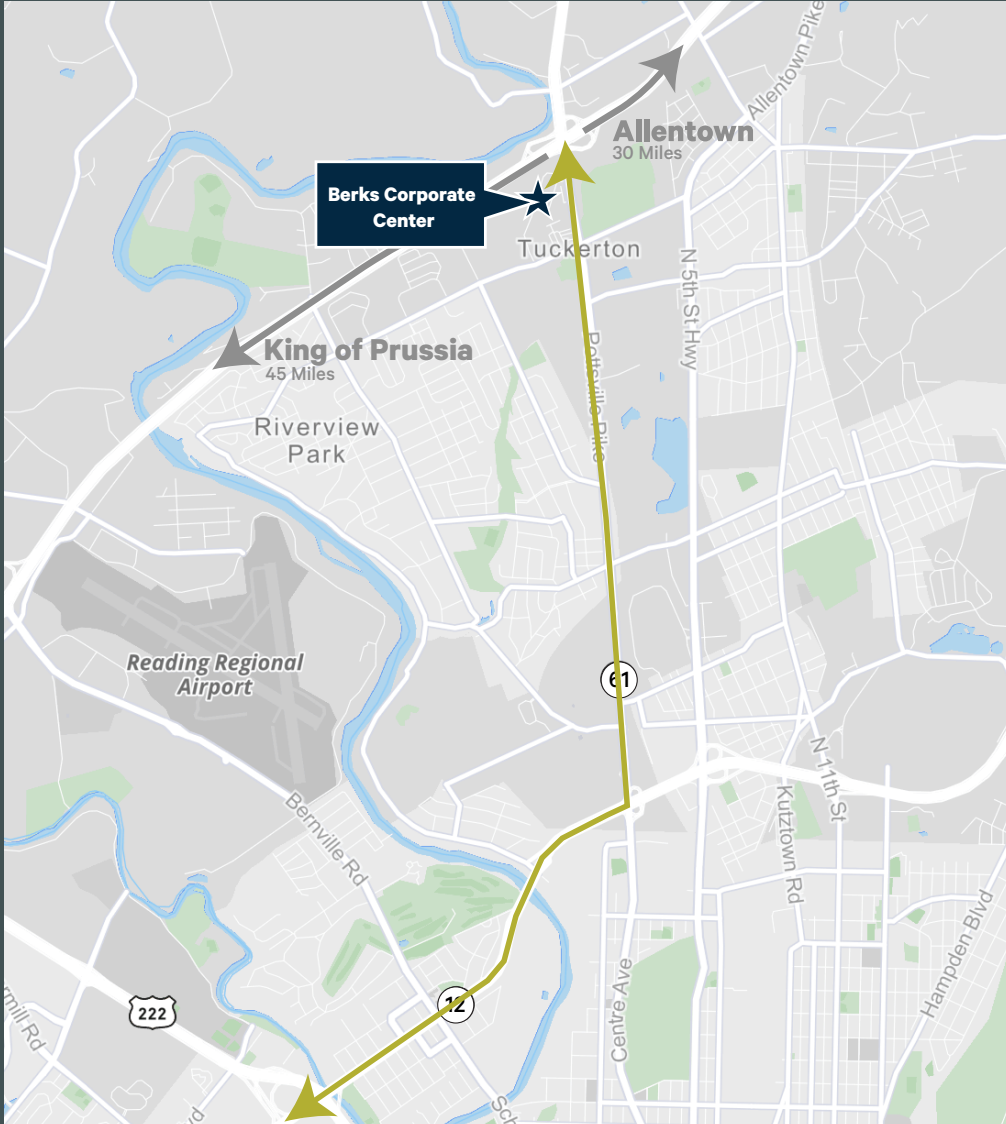

# Floor Plan

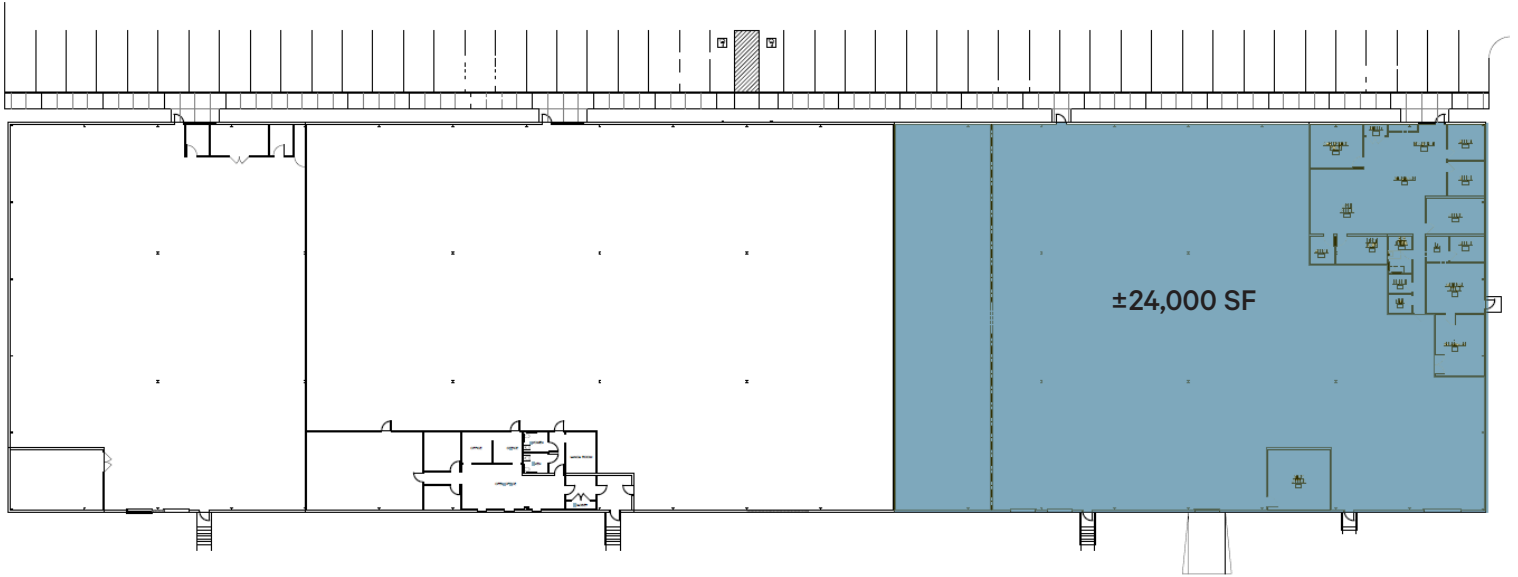

## Building Highlights

**Available Square Footage:** ±24,000SF

**Loading:** Two (2) 8' X 8' loading docks

**Warehouse Area:** ±20,635 SF

**Gas:** UGI Utilities

**Office Area:** ±3,365 SF

**Sewer:** Muhlenberg Township Authority

**Ceiling Height:** 24'

**Water:** Muhlenberg Township Authority

**Column Spacing:** 41' x 47'

**Year Built:** 1997

**Parking:** 1/1,000 SF Parking Ratio with Ability to Accommodate Additional Spaces

**Zoning:** I-1 - Limited Industrial District, Muhlenberg Township, Berks County

# Regional Map

## REGIONAL CONNECTIONS

Downtown Reading	6 Miles
Kutztown	13 Miles
Allentown	40 Miles
King of Prussia	45 Miles
Philadelphia	69 Miles
New York City	130 Miles



## Contact Us

**John LaPrise**  
Associate  
+1 610 251 5126  
john.laprise@cbre.com  
Lic. PA

**Paul Touhey**  
Executive Vice President  
+1 610 251 5126  
paul.touhey@cbre.com  
Lic. PA, NJ, DE

**CBRE, Inc.**  
555 E. Lancaster Avenue  
Suite 120, Radnor, PA 19087  
+1 610 251 0820  
Licensed Real Estate Broker

© 2024 CBRE, Inc. All rights reserved. This information has been obtained from sources believed reliable, but has not been verified for accuracy or completeness. You should conduct a careful, independent investigation of the property and verify all information. Any reliance on this information is solely at your own risk. CBRE and the CBRE logo are service marks of CBRE, Inc. All other marks displayed on this document are the property of their respective owners, and the use of such logos does not imply any affiliation with or endorsement of CBRE. Photos herein are the property of their respective owners. Use of these images without the express written consent of the owner is prohibited.