

Industrial & Logistics | For Lease

Berks Corporate Center

400 Corporate Drive, Suite 410

Reading, Pennsylvania

For Lease: ±88,000 SF (divisible to 41,687SF) Warehouse / Manufacturing



Site Plan



Location Map

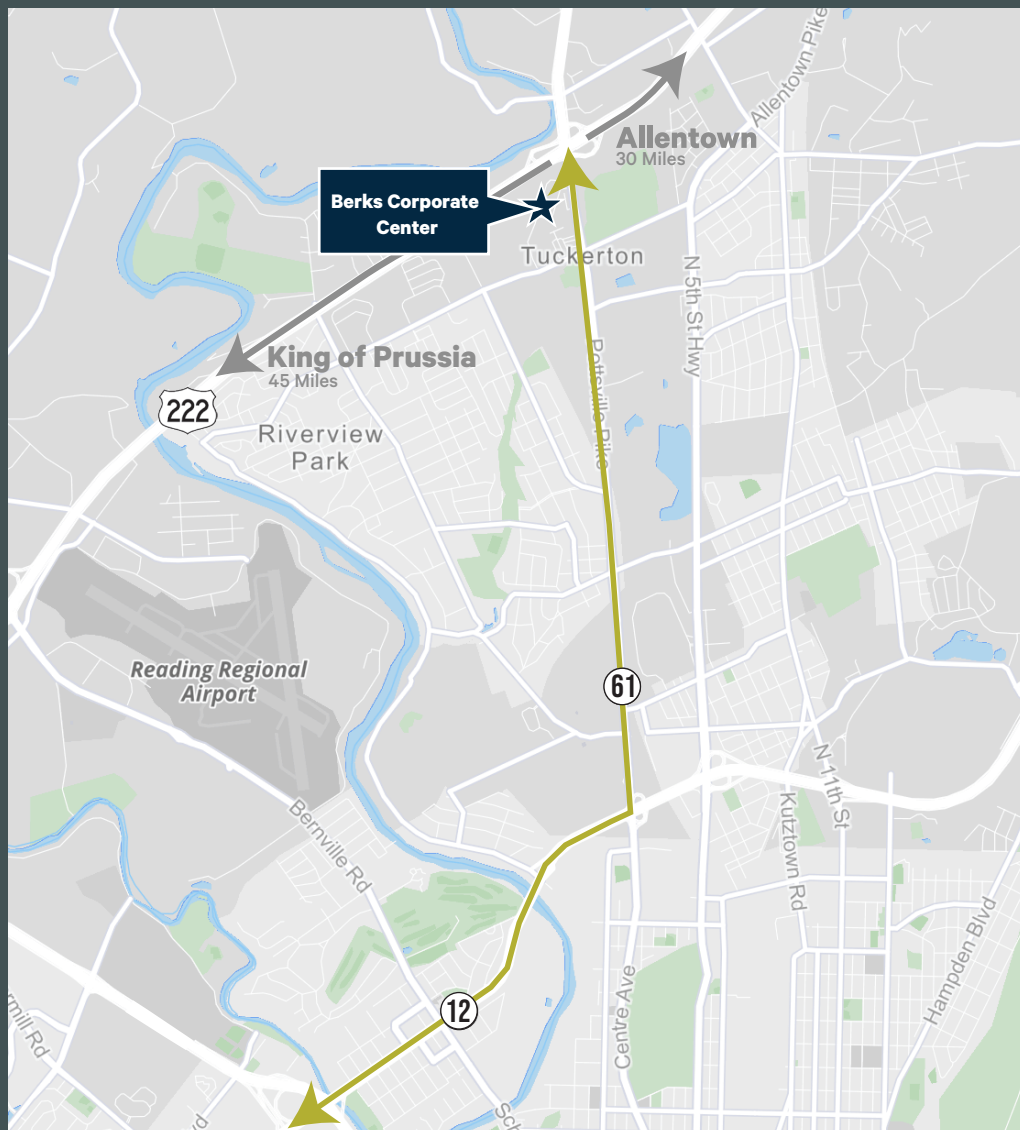

Floor Plan

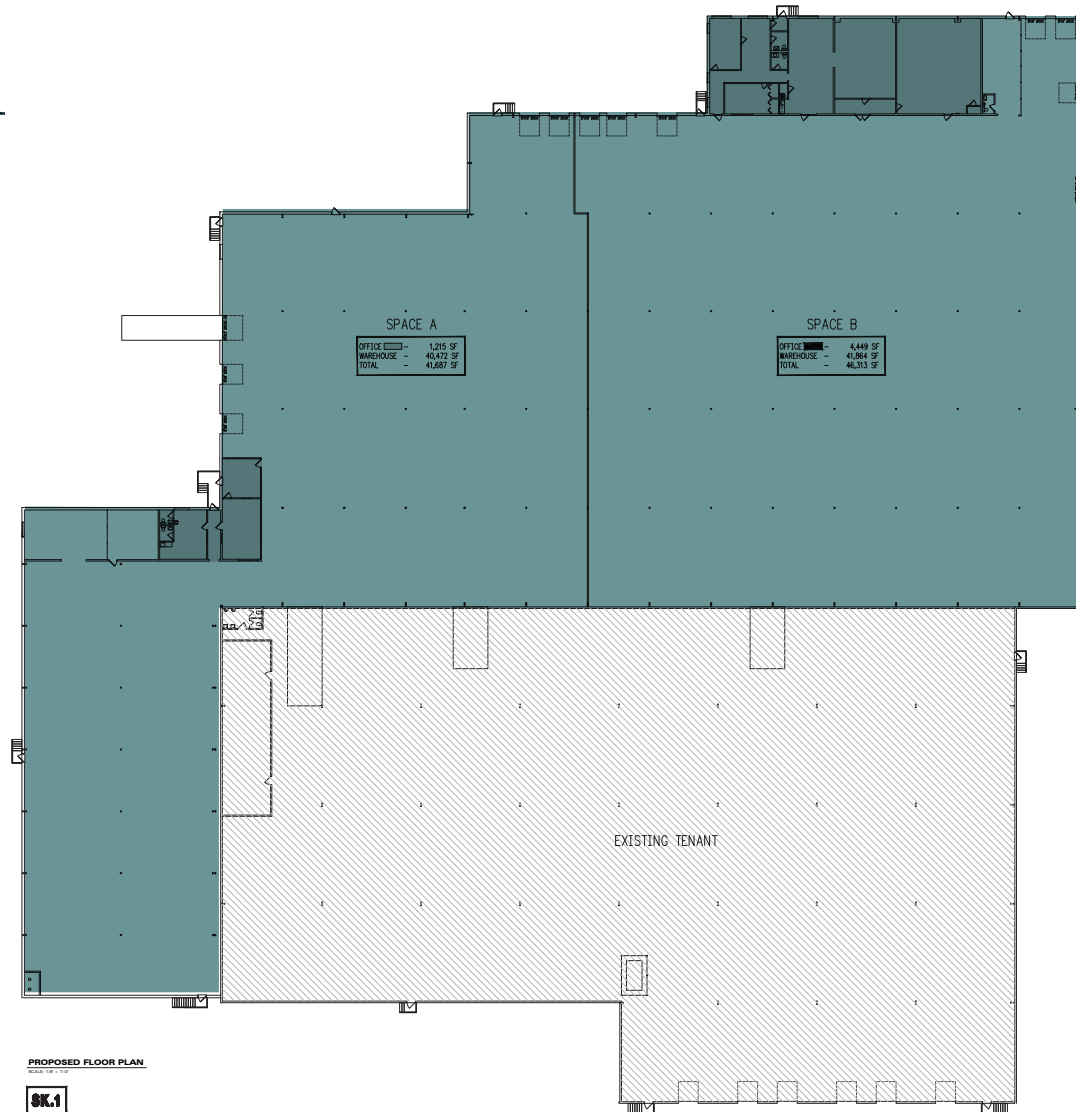

Building Highlights

| | | | |
|------------------------|--|-------------------------|--|
| Available SF: | ±88,000 SF (Divisible to 41,687 SF) | Loading: | Nine (9) Loading Docks |
| Office Area: | 5,664 SF | Gas: | UGI Utilities |
| Warehouse Area: | 82,336 SF | Sewer / Water: | Muhlenberg Township Authority |
| Ceiling Height: | 25' Clear at Peak | Fire Supression: | Wet Sprinkler System |
| Column Spacing: | 39' 4" x 25' | Electric: | Metropolitan Edison Company |
| Car Parking: | Approximately 1.4 acres of macadam area abuts the space. | Zoning: | I-1 - Limited Industrial District, Muhlenberg Township, Berks County |

Site Location



Contact Us

John La Prise

Vice President
+1 484 567 3351
john.laprise@cbre.com
Lic. PA

Nicholas Sather

Associate
+1 717 540 2709
nicholas.sather@cbre.com
Lic. PA

Paul Touhey

Executive Vice President
+1 610 251 5126
paul.touhey@cbre.com
Lic. PA, NJ, DE

Tucker McBride

Associate
+1 610 804 4053
tucker.mcbride@cbre.com
Lic. PA

CBRE, Inc.

555 E. Lancaster Avenue
Suite 120, Radnor, PA 19087
+1 610 251 0820
Licensed Real Estate Broker

© 2024 CBRE, Inc. All rights reserved. This information has been obtained from sources believed reliable, but has not been verified for accuracy or completeness. You should conduct a careful, independent investigation of the property and verify all information. Any reliance on this information is solely at your own risk. CBRE and the CBRE logo are service marks of CBRE, Inc. All other marks displayed on this document are the property of their respective owners, and the use of such logos does not imply any affiliation with or endorsement of CBRE. Photos herein are the property of their respective owners. Use of these images without the express written consent of the owner is prohibited.