



Exit 37  
(Street Rd)

# 40,888 SF Available

Under New Ownership with Planned Exterior Capital Improvements

**3350 Progress Drive, Bensalem, PA**



# Property overview



## PROPERTY OVERVIEW

**Address** 3350 Progress Drive, Bensalem, PA

**Description** 3350 Progress Drive is an industrial/flex property located within Bensalem's established business corridor, offering convenient access to I-95, the Pennsylvania Turnpike (I-276), and Route 1 for strong regional connectivity throughout Greater Philadelphia and Southern New Jersey. Surrounded by industrial, warehouse, and commercial users, the property is well-positioned for manufacturing, distribution, storage, or service-oriented operations within one of the region's most active industrial submarkets.

**Square Footage** 40,888 SF

**Office Build-Out** 3,212 SF

**Acreage** 2.45 AC

**Clear Height** 18' 6"

**Column Spacing** 40' X 40'

**Loading Docks** Four (4) 8' x 10' loading docks  
Expandable to 7 docks

**Power** 400 amps @ 120/208

**Sprinkler System** Wet

**Zoning** G-I (General Industrial District)

**Lighting** LED

**Roof** Replacement scheduled by Q3 2026

**Notes** Under new ownership with planned exterior capital improvements, including fresh exterior paint, parking lot paving, and enhanced landscaping.



# Floor plan

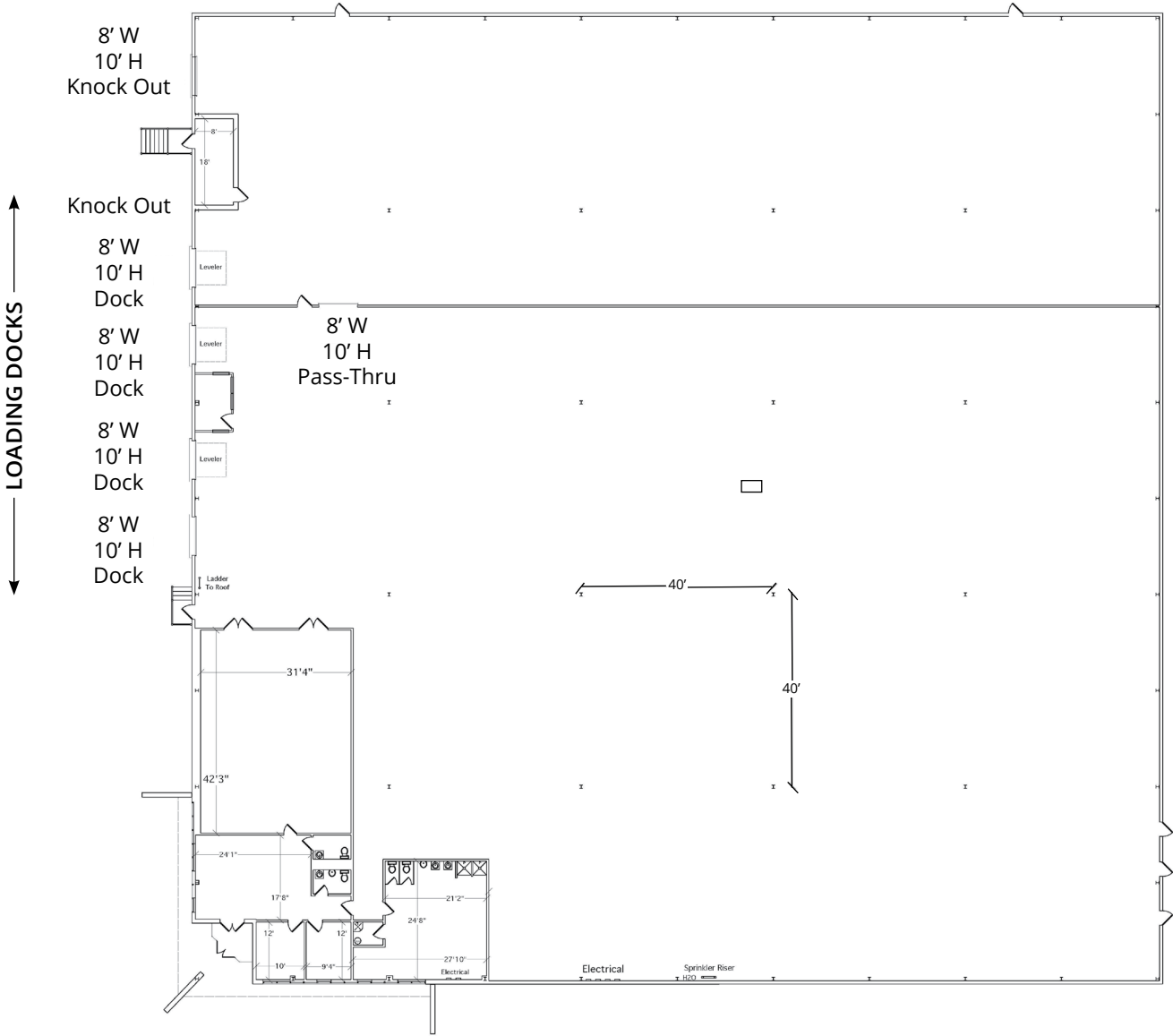

# Amenities/Demographics



	Labor Statistics		
	15 min	30 min	60 min
<b>Housing</b>			
Total Housing Units	145,583	1,249,639	3,213,096
<b>Employment</b>			
Labor Force Population	178,179	1,481,917	4,048,603
<b>Businesses</b>			
Blue Collar Employees	47,813	346,213	964,935
<b>Income</b>			
Average Household Income	\$103,655	\$117,422	\$137,674
Median Household Income	\$79,258	\$87,873	\$105,790
<b>Population</b>			
Total Current Population	346,601	2,834,481	7,798,607
Daytime Population	308,942	2,567,727	7,071,146

# Road access map



# Location overview



**AVISON  
YOUNG**

3350 Progress Drive is strategically located within Bensalem's established industrial corridor, offering immediate access to I-95, the Pennsylvania Turnpike (I-276), and Route 1 for exceptional connectivity throughout Greater Philadelphia, Southern New Jersey, and the Northeast Corridor. The property benefits from proximity to major distribution networks, dense surrounding population centers, and a strong concentration of industrial, commercial, and retail amenities, making it an ideal location for a wide range of business operations.

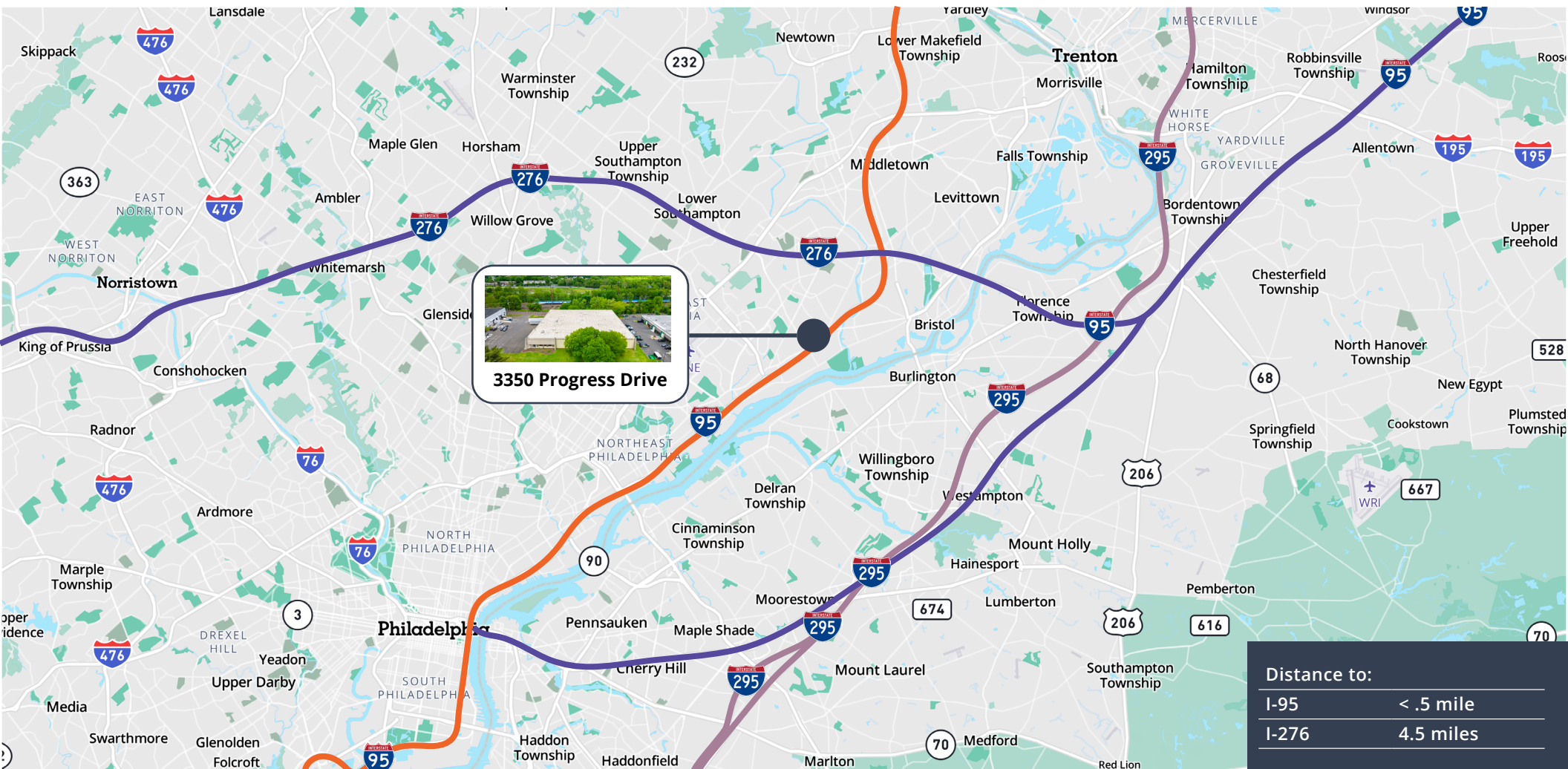

# Building photography



# Get more information:

## **Jim Scott**

Principal

215 932 1157

[jim.scott@avisonyoung.com](mailto:jim.scott@avisonyoung.com)

## **Jack Owens**

Associate

484 343 5545

[jack.owens@avisonyoung.com](mailto:jack.owens@avisonyoung.com)

## **Endurance Real Estate Group**

[Click here to learn more.](#)

**Avison Young – Philadelphia, LLC** | 300 Barr Harbor Drive, Suite 150, Conshohocken, PA 19428 | 610.276.1080

© 2026. Avison Young. Information contained herein was obtained from sources deemed reliable and, while thought to be correct, have not been verified. Avison Young does not guarantee the accuracy or completeness of the information presented, nor assumes any responsibility or liability for any errors or omissions therein.

